

PUBLIC PATH DIVERSION ORDER

HIGHWAYS ACT 1980

WILDLIFE AND COUNTRYSIDE ACT 1981

WORCESTERSHIRE COUNTY COUNCIL

DIVERSION OF FOOTPATHS

FH-552(PART) & FH-553(PART) (FORMERLY FOOTPATH 91)

FH-579(PART), FH-580, & FH-581(PART) (FORMERLY FOOTPATH 99), and

FH-586(PART) (FORMERLY FOOTPATH 100)

IN THE PARISH OF FECKENHAM

PUBLIC PATH DIVERSION AND DEFINITIVE MAP MODIFICATION ORDER 2023

This Order is made by Worcestershire County Council ('the authority') under Section 119 of the Highways Act 1980 ('the 1980 Act') because it appears to the authority that in the interests of the owners of the land crossed by the footpaths and described in paragraph 1 of this order, it is expedient that the line of the footpath should be diverted.

This Order is also made under section 53A(2) of the Wildlife and Countryside Act 1981 ('the 1981 Act') because it appears to the authority that the County of Worcestershire definitive map and statement require modification in consequence of the occurrence of an event specified in section 53(3)(a)(i) of the 1981 Act, namely, the diversion (as authorised by this Order) of a highway shown or required to be shown in the map and statement.

The applicant has agreed to defray any compensation which becomes payable in consequence of the coming into force of this Order and any expenses which are incurred in bringing the new site of the footpath into a fit condition for use by the public ('the works to the new site').

Redditch Borough Council have been consulted about the making of the Order as required by Section 120(2) of the 1980 Act.

BY THIS ORDER:

1. The public right of way over the land situated at Feckenham and shown by a bold continuous line on the map contained in this Order and described in Part 1 of the Schedule to this Order shall be stopped up on the date of confirmation of this order, and thereupon the County of Worcestershire definitive map and statement shall be modified accordingly.
2. Notwithstanding this Order any statutory undertaker as shall for the time being have statutory powers in that respect shall have the right to open up the land referred to in paragraph 1 to install, maintain or alter their apparatus.
3. There shall on the date of confirmation of this order be a public footpath over the land situated in Feckenham described in Part 2 of the Schedule and shown by a bold broken line on the map attached to this Order, and thereupon the County of Worcestershire definitive map and statement shall be modified accordingly

4. The County of Worcestershire definitive statement shall be modified as described in Part 4 of the schedule of this Order.

5. The rights conferred on the public under this Order shall be subject to the limitations and conditions set out in Part 3 of the Schedule.

Dated 4 May 2023

The Common Seal of

Worcestershire County Council

was affixed hereto in the presence of:

Thomas Pollock

Head of Commercial Law (Legal and Governance)

SCHEDULE

PART 1

Description of Site of Existing Footpaths

FOOTPATH FH-552 (PART) (FORMERLY FOOTPATH 91)

The length and entire width of footpath FH-552, in the parish of Feckenham, to be diverted commences at Ordnance Survey grid reference (OSGR) SP 0026 6237 (point A on the Order map). The path proceeds in a north north-westerly direction for 68 metres to terminate at its junction with footpaths FH-553, FH-580, and FH-581, at OSGR SP 0024 6243 (point B on the Order map).

The total distance of footpath to be diverted is 68 metres.

FOOTPATH FH-553 (PART) (FORMERLY FOOTPATH 91)

The length and entire width of footpath FH-553, in the parish of Feckenham, to be diverted commences at Ordnance Survey grid reference (OSGR) SP 0024 6243 (point B on the Order map). The path proceeds in a north by westerly then northerly direction for 23 metres to terminate at the edge of a track at OSGR SP 0023 6245 (point C on the Order map).

The total distance of footpath to be diverted is 23 metres.

The foregoing order is hereby confirmed

Jennifer Ingram 24 Feb 25

An Inspector appointed by the Secretary of State for Environment, Food and Rural Affairs

FOOTPATH FH-579 {PART} (FORMERLY FOOTPATH 99)

The length and entire width of footpath FH-579, in the parish of Feckenham, to be diverted commences at Ordnance Survey grid reference (OSGR) SP 0030 6247 (point Don the Order map). The path proceeds in a west north-westerly direction for 11 metres to terminate at its junction with footpaths FH-580 and FH-586 at OSGR SP 0029 6247 (point Eon the Order map).

The total distance of footpath to be diverted is 11 metres.

FOOTPATHS FH-580 (FORMERLY FOOTPATH 99)

The length and entire width of footpath FH-580, in the parish of Feckenham, to be diverted commences at Ordnance Survey grid reference (OSGR) SP 0029 6247 (point E on the Order map). The path proceeds in a west by southerly direction for 9 metres, then west north- westerly and westerly for 13 metres, turning south south-westerly for 31 metres and south- westerly for 26 metres to terminate at its junction with footpaths FH-552, FH-553, and FH-581, at OSGR SP 0024 6243 (Point Bon the Order map)

The total distance of footpath to be extinguished is 79 metres.

FOOTPATH FH-581 {PART} (FORMERLY FOOTPATH 99)

The length and entire width of footpath FH-581, in the parish of Feckenham, to be diverted commences at Ordnance Survey grid reference (OSGR) SP 0024 6243 (point B on the Order map). The path proceeds in a west south-westerly direction for 121 metres to terminate at OSGR SP 0012 6239 (point Fon the Order map).

The total distance of footpath to be diverted is 121 metres.

FOOTPATH FH-586 {PART} (FORMERLY FOOTPATH 100)

The length and entire width of footpath FH-586 in the parish of Feckenham, to be diverted commences at Ordnance Survey grid reference (OSGR) SP 0030 6248 (point G on the Order map). The path proceeds in a west by southerly direction for 12 metres to terminate at its junction with footpaths FH-579 and FH-580 at OSGR SP 0029 6247 (point Eon the Order map).

The total distance of footpath to be diverted is 12 metres.

PART 2

Description of Site of New Footpaths

FOOTPATH FH-552 {PART} (FORMERLY FOOTPATH 91)

The length of footpath FH-552 (part) in the parish of Feckenham has width of 2 metres and commences at a gate at Ordnance Survey grid reference (OSGR) SP 0026 6237 (point A on the Order map). The path proceeds in a north-west by northerly direction, across a field for 72 metres, to a gate at OSGR SP 0022 6242 (Point Kon the Order map). The path continues across a residential driveway in a north-west by northerly direction, through a gate at OSGR SP 0022 6243 (Point Lon the Order map) and across a small field for 24 metres, to a gate at OSGR SP 0021 6244 (Point M on the Order map) where it terminates at the edge of a track at its junction with footpaths FH-581 and FH-553.

The total distance of diverted footpath is 96 metres.

FOOTPATH FH-553 (PARJ) (FORMERLY FOOTPATH 91)

The length of footpath FH-553 (part) in the parish of Feckenham has width of 2 metres and commences at Ordnance Survey grid reference (OSGR) SP 0021 6244 (Point Mon the Order map). The path proceeds in an east north-easterly direction for 32 metres to terminate at OSGR SP 0023 6245 (Point Con the Order map).

The total distance of diverted footpath is 32 metres.

FOOTPATH FH-579 (PART) (FORMERLY FOOTPATH 99)

The length of footpath FH-579 (part) in the parish of Feckenham has width of 2 meters on the east side of the hedge and commences at Ordnance Survey grid reference (OSGR) SP 0030 6247 (Point D on the Order map). The path proceeds in a south by westerly direction along the field edge for 103 metres to OSGR SP 0028 6237 (Point Jon the Order map). The path then turns in a westerly direction, through a gate at OSGR SP 0028 6237 (Point J on the Order map) and along the field edge for 23 metres to terminate at its junction with footpath FH-552 at OSGR SP 0026 6237 (point A on the Order map).

The total distance of diverted footpath is 126 metres.

FOOTPATHS FH-580 and FH-581 (PART) (FORMERLY FOOTPATH 99)

Footpaths FH580 and FH-581 will become footpath FH-581 only.

The length of footpath FH-581 (part) in the parish of Feckenham has a width of 2 meters and commences at Ordnance Survey grid reference (OSGR) OSGR SP 0021 6244 (point M on the Order map) at its junction with footpaths FH-552 and FH553. The path proceeds along a track in a west direction, turning in a south westerly direction for 108 metres to terminate at (OSGR) SP 0012 6239 (point Fon the Order map).

The total distance of diverted footpath is 108 metres.

FOOTPATH EH-586 (PART) (FORMERLY FOOTPATH 100)

The length of footpath FH-586 (part) in the parish of Feckenham has width of 2 metres on the east side of the hedge and commences at Ordnance Survey grid reference (OSGR) SP 0030 6248 (point G on the Order map). The path proceeds in a south by westerly direction for 7 metres to terminate at its junction with footpath FH-579 at OSGR SP 0030 6247 (point Don the Order map).

Total distance of diverted footpath is 7 metres.

PART 3

Limitations and Conditions

Position on path to which Limitations and Conditions apply

OS grid reference SP 0022 6242 (Point K)
OS grid reference SP 0022 6243 (Point L)
OS grid reference SP 0021 6244 (Point M)
OS grid reference SP 0028 6237 (Point J)

Limitations and Conditions

Gate (conforming to British Standard)
Gate (conforming to British Standard)
Gate (conforming to British Standard)
Gate (conforming to British Standard)

PART 4

Modification of Definitive Statement

Variation of Particulars of Path

(Variations to definitive statement shown in bold, text to be removed struck through)

Parish of Feckenham

Borough of Redditch (Formerly Urban District of Redditch)

FOOTPATHS FH-552, FH-553, FH-554, FH-555, and FH-556 {FORMERLY FOOTPATH 91}

6-inch Ordnance Map Reference. Worcs XXX NW & XX Ill SW.

Definitive Map grid: 06-9 and 06-13

CLASSIFICATION

Footpath

LOCATION

Generally northwards from a point on CRB 19 about 150 yards east of its junction with Berrowhill Lane. **Commencing at a gate at OSGR SP 0026 6237 a width of 2 metres path proceeds in a north-west by northerly direction, across a field for 72 metres, to a gate at OSGR SP 0022 6242. The path continues across a residential driveway in a north- west by northerly direction, through a gate at OSGR SP 0022 6243, across a small field for 24 metres to a gate at OSGR SP 0021 6244 and junction with footpath FH-581. It then proceeds through the gate in an east north-easterly direction for 32 metres to OSGR SP 0023 6245. It then continues in a northerly direction to Trickse's Hole with a branch to Cruise Hill.**

LENGTH 2584 metres (2.58 kilometres)

DESCRIPTION General A little used and poorly defined path via Berrowhill Farm, and Lower Berrow Hill Farm. **Gate at OSGR SP 0026 6237, across field to gate at OSGR SP 0022 6242. Across residential driveway, through gate at OSGR SP 0022 6243, field, gate OSGR SP 0021 6244, track to OSGR SP 0023 6245.** From Lower Berrow Farm to Trickse's Hole the path has been completely obliterated and no trace remains. The practice seems to be to follow the occupational road to Cruise Hill.

Stiles, Gates Field gates where they exist seem reasonable, no stiles are to be found in some places, gaps do service in others no facility is provided and hedges block the right of way. **Gate at OSGR SP 0026 6237; Gate at OSGR SP 0022 6242; Gate at OSGR SP 0022 6243; Gate at OSGR SP 0021 6244**

Stream Crossings None

Direction Posts None

Notices None

EVIDENCE OF EXISTENCE OF PUBLIC RIGHTS Shown on earliest ordnance survey maps of the district with undisputed access in living memory.

BY WHOM REPAIRABLE Landowner

CONDITIONS AT TIME OF INSPECTION

Special features

Little used and poorly defined frequently obstructed.

MAP OR PLAN REFERENCE 4004 - 2621

REMARKS

BY WHOM INSPECTED

J G Rollins

DATE OF INSPECTION

May 1952

Modification of Definitive Statement

Variation of Particulars of Path

(Variations to definitive statement shown in bold, text to be removed struck through)

Parish of Feckenham

Borough of Redditch (Formerly Urban District of Redditch)

FOOTPATHS FH-575, 576, 577, 578, 579, HQ, 581, 582, 583, and 584 {FORMERLY FOOTPATH 99}

6-inch Ordnance Map Reference. Worcs XXX NW

Definitive Map grid: 06-9 and 06-13

CLASSIFICATION

Footpath

LOCATION (Section 1)

Generally westward from a point on Swanbrook Lane about 250 yards North of Feckenham School to **Ordnance Survey grid reference (OSGR) SP 0030 6247 with a width of 2 metres on the east side of the hedge. The path proceeds in a south by westerly direction along the field edge for 103 metres to OSGR SP 0028 6237. The path then turns in a westerly direction, through a gate at OSGR SP 0028 6237 and along the field edge for 23 metres to terminate at its junction with footpath FH-552 at OSGR SP 0026 6237.**

LOCATION (Section 2)

Commencing at Ordnance Survey grid reference OSGR SP 0021 6244 with a width of 2 metres at its junction with footpaths FH-552 and FH553. The path proceeds along a track in a west direction, turning in a south westerly direction for 108 metres to at OSGR SP 0012 6239 and then continues to meet Berrowhill Lane north of Berrowhill House with a branch to footpath 30 100 and a second branch from the branch itself back to Burial Lane.

LENGTH 1820 metres (1.8 kilometres)

DESCRIPTION General: This was once a bridleway but one of the bounding hedges has been removed and the highway thrown into the adjoining fields. Ploughing has now rendered part of the path difficult but it is still passable; the point where it crosses Burial Lane is subject to flooding. **OSGR SP 0030 6247 field edge to OSGR SP 0028 6237. Through gate. Field edge to OSGR SP 0026 6237. OSGR SP 0012 6239, track to OSGR SP 0021 6244.**

Stiles, Gates Field gates in reasonable repair. Gate at OSGR SP 0028 6237.

Stream Crossings A ford and stepping stones exist at the Swan Brook Crossing.

Direction Posts None

Notices None

EVIDENCE OF EXISTENCE OF PUBLIC RIGHTS Shown on earliest ordnance survey maps of the district with undisputed access in living memory.

BY WHOM REPAIRABLE Landowners

CONDITIONS AT TIME OF INSPECTION

Special features

Poorly defined and in places difficult but still passable

REMARKS B.T. Lee

J.G. Rollins

BY WHOM INSPECTED

B.T. Lee

J G Rollins

DATE OF INSPECTION

Feb 1952

May 1952

Modification of Definitive Statement

Variation of Particulars of Path

(Variations to definitive statement shown in bold, text to be removed struck through)

Parish of Feckenham

Borough of Redditch (Formerly Urban District of Redditch)

FOOTPATHS FH-585 AND FH-586 (FORMERLY FOOTPATH 100)

6-inch Ordnance Map Reference. Worcs XXX NW

Definitive Map grid: 06-9 and 06-13

CLASSIFICATION

Footpath

LOCATION

Generally southwestwards from a point on Burial Lane about 1/2 a mile south of Cruise Hill. **With a width of 2 metres from Ordnance Survey grid reference (OSGR) SP 0030 6248 on the east side of the hedge. The path proceeds in a south by westerly direction for 7 metres to terminate at its junction with footpath FH-579 at OSGR SP 0030 6247. Berrowhill House via. East of Old Berrowhill Farm.**

LENGTH 673 metres (0.67 kilometres)

DESCRIPTION General: Ill defined and practically disused except for a short length used as a field road.

Stiles, Gates Poor state of repair.

Stream Crossings None.

Direction Posts None

Notices None.

EVIDENCE OF EXISTENCE OF PUBLIC RIGHTS Shown on earliest ordnance survey maps of the district with undisputed access in living memory.

BY WHOM REPAIRABLE Landowner

CONDITIONS AT TIME OF INSPECTION**Special features**

Ill defined and practically disused but still accessible.

MAP OR PLAN REFERENCE 4008 -2630

REMARKS**BY WHOM INSPECTED**

B.T. Lee

J G Rollins

DATE OF INSPECTION

Feb 1952

May 1952



PUBLIC PATH DIVERSION ORDER

**HIGHWAYS ACT 1980
WILDLIFE AND COUNTRYSIDE ACT 1981**

WORCESTERSHIRE COUNTY COUNCIL

**DIVERSION OF FOOTPATHS
FH-552(PART) & FH-553(PART) (FORMERLY FOOTPATH 91)
FH-579(PART), FH-580, & FH-581(PART) (FORMERLY FOOTPATH 99), and
FH-586(PART) (FORMERLY FOOTPATH 100)
IN THE PARISH OF FECKENHAM**

PUBLIC PATH DIVERSION AND DEFINITIVE MAP MODIFICATION ORDER 2023

This Order is made by Worcestershire County Council ('the authority') under Section 119 of the Highways Act 1980 ('the 1980 Act') because it appears to the authority that in the interests of the owners of the land crossed by the footpaths and described in paragraph 1 of this order, it is expedient that the line of the footpath should be diverted.

This Order is also made under section 53A(2) of the Wildlife and Countryside Act 1981 ('the 1981 Act') because it appears to the authority that the County of Worcestershire definitive map and statement require modification in consequence of the occurrence of an event specified in section 53(3)(a)(i) of the 1981 Act, namely, the diversion (as authorised by this Order) of a highway shown or required to be shown in the map and statement.

The applicant has agreed to defray any compensation which becomes payable in consequence of the coming into force of this Order and any expenses which are incurred in bringing the new site of the footpath into a fit condition for use by the public ('the works to the new site').

Redditch Borough Council have been consulted about the making of the Order as required by Section 120(2) of the 1980 Act.

BY THIS ORDER:

1. The public right of way over the land situated at Feckenham and shown by a bold continuous line on the map contained in this Order and described in Part 1 of the Schedule to this Order shall be stopped up on the date of confirmation of this order, and thereupon the County of Worcestershire definitive map and statement shall be modified accordingly.
2. Notwithstanding this Order any statutory undertaker as shall for the time being have statutory powers in that respect shall have the right to open up the land referred to in paragraph 1 to install, maintain or alter their apparatus.
3. There shall on the date of confirmation of this order be a public footpath over the land situated in Feckenham described in Part 2 of the Schedule and shown by a

bold broken line on the map attached to this Order, and thereupon the County of Worcestershire definitive map and statement shall be modified accordingly

4. The County of Worcestershire definitive statement shall be modified as described in Part 4 of the schedule of this Order.
5. The rights conferred on the public under this Order shall be subject to the limitations and conditions set out in Part 3 of the Schedule.

Dated 4 May 2023

The Common Seal of
Worcestershire County Council
was affixed hereto in the presence of:-



SCHEDULE

PART 1

Thomas Pollock
Head of Commercial Law
(Land & Governance)

Description of Site of Existing Footpaths

FOOTPATH FH-552 (PART) (FORMERLY FOOTPATH 91)

The length and entire width of footpath FH-552, in the parish of Feckenham, to be diverted commences at Ordnance Survey grid reference (OSGR) SP 0026 6237 (point A on the Order map). The path proceeds in a north north-westerly direction for 68 metres to terminate at its junction with footpaths FH-553, FH-580, and FH-581, at OSGR SP 0024 6243 (point B on the Order map).

The total distance of footpath to be diverted is 68 metres.

FOOTPATH FH-553 (PART) (FORMERLY FOOTPATH 91)

The length and entire width of footpath FH-553, in the parish of Feckenham, to be diverted commences at Ordnance Survey grid reference (OSGR) SP 0024 6243 (point B on the Order map). The path proceeds in a north by westerly then northerly direction for 23 metres to terminate at the edge of a track at OSGR SP 0023 6245 (point C on the Order map).

The total distance of footpath to be diverted is 23 metres.

The foregoing order is hereby confirmed

Jennifer Ingram 24 FEB 2025
An Inspector appointed by The Secretary of
State for Environment, Food and
Rural Affairs

FOOTPATH FH-579 (PART) (FORMERLY FOOTPATH 99)

The length and entire width of footpath FH-579, in the parish of Feckenham, to be diverted commences at Ordnance Survey grid reference (OSGR) SP 0030 6247 (point D on the Order map). The path proceeds in a west north-westerly direction for 11 metres to terminate at its junction with footpaths FH-580 and FH-586 at OSGR SP 0029 6247 (point E on the Order map).

The total distance of footpath to be diverted is 11 metres.

FOOTPATHS FH-580 (FORMERLY FOOTPATH 99)

The length and entire width of footpath FH-580, in the parish of Feckenham, to be diverted commences at Ordnance Survey grid reference (OSGR) SP 0029 6247 (point E on the Order map). The path proceeds in a west by southerly direction for 9 metres, then west north- westerly and westerly for 13 metres, turning south south-westerly for 31 metres and south- westerly for 26 metres to terminate at its junction with footpaths FH-552, FH-553, and FH-581, at OSGR SP 0024 6243 (Point B on the Order map)

The total distance of footpath to be extinguished is 79 metres.

FOOTPATH FH-581 (PART) (FORMERLY FOOTPATH 99)

The length and entire width of footpath FH-581, in the parish of Feckenham, to be diverted commences at Ordnance Survey grid reference (OSGR) SP 0024 6243 (point B on the Order map). The path proceeds in a west south-westerly direction for 121 metres to terminate at OSGR SP 0012 6239 (point F on the Order map).

The total distance of footpath to be diverted is 121 metres.

FOOTPATH FH-586 (PART) (FORMERLY FOOTPATH 100)

The length and entire width of footpath FH-586 in the parish of Feckenham, to be diverted commences at Ordnance Survey grid reference (OSGR) SP 0030 6248 (point G on the Order map). The path proceeds in a west by southerly direction for 12 metres to terminate at its junction with footpaths FH-579 and FH-580 at OSGR SP 0029 6247 (point E on the Order map).

The total distance of footpath to be diverted is 12 metres.

PART 2

Description of Site of New Footpaths

FOOTPATH FH-552 (PART) (FORMERLY FOOTPATH 91)

The length of footpath FH-552 (part) in the parish of Feckenham has width of 2 metres and commences at a gate at Ordnance Survey grid reference (OSGR) SP 0026 6237 (point A on the Order map). The path proceeds in a north-west by northerly direction, across a field for 72 metres, to a gate at OSGR SP 0022 6242 (Point K on the Order map). The path continues across a residential driveway in a north-west by northerly direction, through a gate at OSGR SP 0022 6243 (Point L on the Order map) and across a small field for 24 metres, to a gate at

OSGR SP 0021 6244 (Point M on the Order map) where it terminates at the edge of a track at its junction with footpaths FH-581 and FH-553.

The total distance of diverted footpath is 96 metres.

FOOTPATH FH-553 (PART) (FORMERLY FOOTPATH 91)

The length of footpath FH-553 (part) in the parish of Feckenham has width of 2 metres and commences at Ordnance Survey grid reference (OSGR) SP 0021 6244 (Point M on the Order map). The path proceeds in an east north-easterly direction for 32 metres to terminate at OSGR SP 0023 6245 (Point C on the Order map).

The total distance of diverted footpath is 32 metres.

FOOTPATH FH-579 (PART) (FORMERLY FOOTPATH 99)

The length of footpath FH-579 (part) in the parish of Feckenham has width of 2 metres on the east side of the hedge and commences at Ordnance Survey grid reference (OSGR) SP 0030 6247 (Point D on the Order map). The path proceeds in a south by westerly direction along the field edge for 103 metres to OSGR SP 0028 6237 (Point J on the Order map). The path then turns in a westerly direction, through a gate at OSGR SP 0028 6237 (Point J on the Order map) and along the field edge for 23 metres to terminate at its junction with footpath FH-552 at OSGR SP 0026 6237 (point A on the Order map).

The total distance of diverted footpath is 126 metres.

FOOTPATHS FH-580 and FH-581 (PART) (FORMERLY FOOTPATH 99)

Footpaths FH580 and FH-581 will become footpath FH-581 only.

The length of footpath FH-581 (part) in the parish of Feckenham has a width of 2 metres and commences at Ordnance Survey grid reference (OSGR) OSGR SP 0021 6244 (point M on the Order map) at its junction with footpaths FH-552 and FH553. The path proceeds along a track in a west direction, turning in a south westerly direction for 108 metres to terminate at (OSGR) SP 0012 6239 (point F on the Order map).

The total distance of diverted footpath is 108 metres.

FOOTPATH FH-586 (PART) (FORMERLY FOOTPATH 100)

The length of footpath FH-586 (part) in the parish of Feckenham has width of 2 metres on the east side of the hedge and commences at Ordnance Survey grid reference (OSGR) SP 0030 6248 (point G on the Order map). The path proceeds in a south by westerly direction for 7 metres to terminate at its junction with footpath FH-579 at OSGR SP 0030 6247 (point D on the Order map).

Total distance of diverted footpath is 7 metres.

PART 3

Limitations and Conditions

Position on path to which Limitations and Conditions apply

OS grid reference SP 0022 6242 (Point K)
OS grid reference SP 0022 6243 (Point L)
OS grid reference SP 0021 6244 (Point M)
OS grid reference SP 0028 6237 (Point J)

Limitations and Conditions

Gate (conforming to British Standard)
Gate (conforming to British Standard)
Gate (conforming to British Standard)
Gate (conforming to British Standard)

PART 4

Modification of Definitive Statement

Variations of Particulars of Paths

(Variations to definitive statement shown in bold, text to be removed struck through)

Parish of Feckenham

Borough of Redditch (Formerly Urban District of Redditch)

FOOTPATHS FH-552, FH-553, FH-554, FH-555, and FH-556 (FORMERLY FOOTPATH 91)

6-inch Ordnance Map Reference. Worcs XXX NW & XX III SW.

Definitive Map grid: 06-9 and 06-13

CLASSIFICATION

Footpath

LOCATION

Generally northwards from a point on CRB 19 about 150 yards east of its junction with Berrowhill Lane. Commencing at a gate at OSGR SP 0026 6237 a width of 2 metres path proceeds in a north-west by northerly direction, across a field for 72 metres, to a gate at OSGR SP 0022 6242. The path continues across a residential driveway in a north-west by northerly direction, through a gate at OSGR SP 0022 6243, across a small field for 24 metres to a gate at OSGR SP 0021 6244 and junction with footpath FH-581. It then proceeds through the gate in an east north-easterly direction for 32 metres to OSGR SP 0023 6245. It then continues in a northerly direction to Trickse's Hole with a branch to Cruise Hill.

LENGTH 2584 metres (2.58 kilometres)

DESCRIPTION General A little used and poorly defined path via Berrowhill Farm, and Lower Berrow Hill Farm. Gate at OSGR SP 0026 6237, across field to gate at OSGR SP 0022

6242. Across residential driveway, through gate at OSGR SP 0022 6243, field, gate OSGR SP 0021 6244, track to OSGR SP 0023 6245. From Lower Berrow Farm to Trickse's Hole the path has been completely obliterated and no trace remains. The practice seems to be to follow the occupational road to Cruise Hill.

Stiles, Gates Field gates where they exist seem reasonable, no stiles are to be found in some places, gaps do service in others no facility is provided and hedges block the right of way. Gate at OSGR SP 0026 6237; Gate at OSGR SP 0022 6242; Gate at OSGR SP 0022 6243; Gate at OSGR SP 0021 6244

Stream Crossings None

Direction Posts None

Notices None

EVIDENCE OF EXISTENCE OF PUBLIC RIGHTS Shown on earliest Ordnance survey maps of the district with undisputed access in living memory.

BY WHOM REPAIRABLE Land owner

CONDITIONS AT TIME OF INSPECTION

Special features

Little used and poorly defined frequently obstructed.

MAP OR PLAN REFERENCE 4004 – 2621

REMARKS

BY WHOM INSPECTED

J.G. Rollins.

DATE OF INSPECTION

May 1952

Modification of Definitive Statement

Variations of Particulars of Paths

(Variations to definitive statement shown in bold, text to be removed struck through)

Parish of Feckenham

Borough of Redditch (Formerly Urban District of Redditch)

FOOTPATHS FH-575, 576, 577, 578, 579, 580, 581, 582, 583, and 584 (FORMERLY FOOTPATH 99)

6-inch Ordnance Map Reference. Worcs XXX NW
Definitive Map grid: 06-9 and 06-13

CLASSIFICATION

Footpath

LOCATION (Section 1)

Generally westward from a point on Swanbrook Lane about 250 yards North of Feckenham School to **Ordnance Survey grid reference (OSGR) SP 0030 6247** with a width of **2 metres on the east side of the hedge**. The path proceeds in a south by westerly direction along the field edge for 103 metres to OSGR SP 0028 6237. The path then turns in a westerly direction, through a gate at OSGR SP 0028 6237 and along the field edge for 23 metres to terminate at its junction with footpath FH-552 at OSGR SP 0026 6237.

LOCATION (Section 2)

Commencing at Ordnance Survey grid reference OSGR SP 0021 6244 with a width of 2 metres at its junction with footpaths FH-552 and FH553. The path proceeds along a track in a west direction, turning in a south westerly direction for 108 metres to at OSGR SP 0012 6239 and then continues to meet Berrowhill Lane north of Berrowhill House with a branch to footpath 30 100 and a second branch from the branch itself back to Burial Lane.

LENGTH 1820 metres (1.8 kilometres)

DESCRIPTION General: This was once a bridleway but one of the bounding hedges has been removed and the highway thrown into the adjoining fields. Ploughing has now rendered part of the path difficult but it is still passable; the point where it crosses Burial Lane is subject to flooding. **OSGR SP 0030 6247 field edge to OSGR SP 0028 6237. Through gate. Field edge to OSGR SP 0026 6237. OSGR SP 0012 6239, track to OSGR SP 0021 6244.**

Stiles, Gates Field gates in reasonable repair. Gate at OSGR SP 0028 6237.

Stream Crossings A ford and stepping stones exist at the Swan Brook Crossing.

Direction Posts None

Notices None

EVIDENCE OF EXISTENCE OF PUBLIC RIGHTS Shown on earliest Ordnance Survey maps of the district with undisputed access in living memory.

BY WHOM REPAIRABLE Landowners

CONDITIONS AT TIME OF INSPECTION

Special features

Poorly defined and in places difficult but still passable.

MAP OR PLAN REFERENCE 4013 - 2622

REMARKS B.T. Lee
J.G. Rollins.

| BY WHOM INSPECTED | DATE OF INSPECTION |
|--------------------------|---------------------------|
| B.T. Lee | Feb 1952 |
| J.G. Rollins. | June 1952 |

Modification of Definitive Statement

Variations of Particulars of Paths

(Variations to definitive statement shown in bold, text to be removed struck through)

Parish of Feckenham

Borough of Redditch (Formerly Urban District of Redditch)

FOOTPATHS FH-585 AND FH-586 (FORMERLY FOOTPATH 100)

6-inch Ordnance Map Reference. Worcs XXX NW

Definitive Map grid: 06-9 and 06-13

CLASSIFICATION

Footpath

LOCATION

Generally southwestwards from a point on Burial Lane about ½ a mile south of Cruise Hill. **With a width of 2 metres from Ordnance Survey grid reference (OSGR) SP 0030 6248 on the east side of the hedge. The path proceeds in a south by westerly direction for 7 metres to terminate at its junction with footpath FH-579 at OSGR SP 0030 6247. ~~Berrowhill House via.~~ East of Old Berrowhill Farm.**

LENGTH 673 metres (0.67 kilometres)

DESCRIPTION General: Ill defined and practically disused except for a short length used as a field road.

Stiles, Gates Poor state of repair.

Stream Crossings None.

Direction Posts None

Notices None.

EVIDENCE OF EXISTENCE OF PUBLIC RIGHTS Shown on earliest Ordnance survey maps of the district with undisputed access in living memory.

BY WHOM REPAIRABLE Land owner

CONDITIONS AT TIME OF INSPECTION

Special features

Ill defined and practically disused but still accessible.

MAP OR PLAN REFERENCE 4008 - 2630

REMARKS

BY WHOM INSPECTED

B.T. Lee

J.G. Rollins.

DATE OF INSPECTION

Feb 1952

June 1952

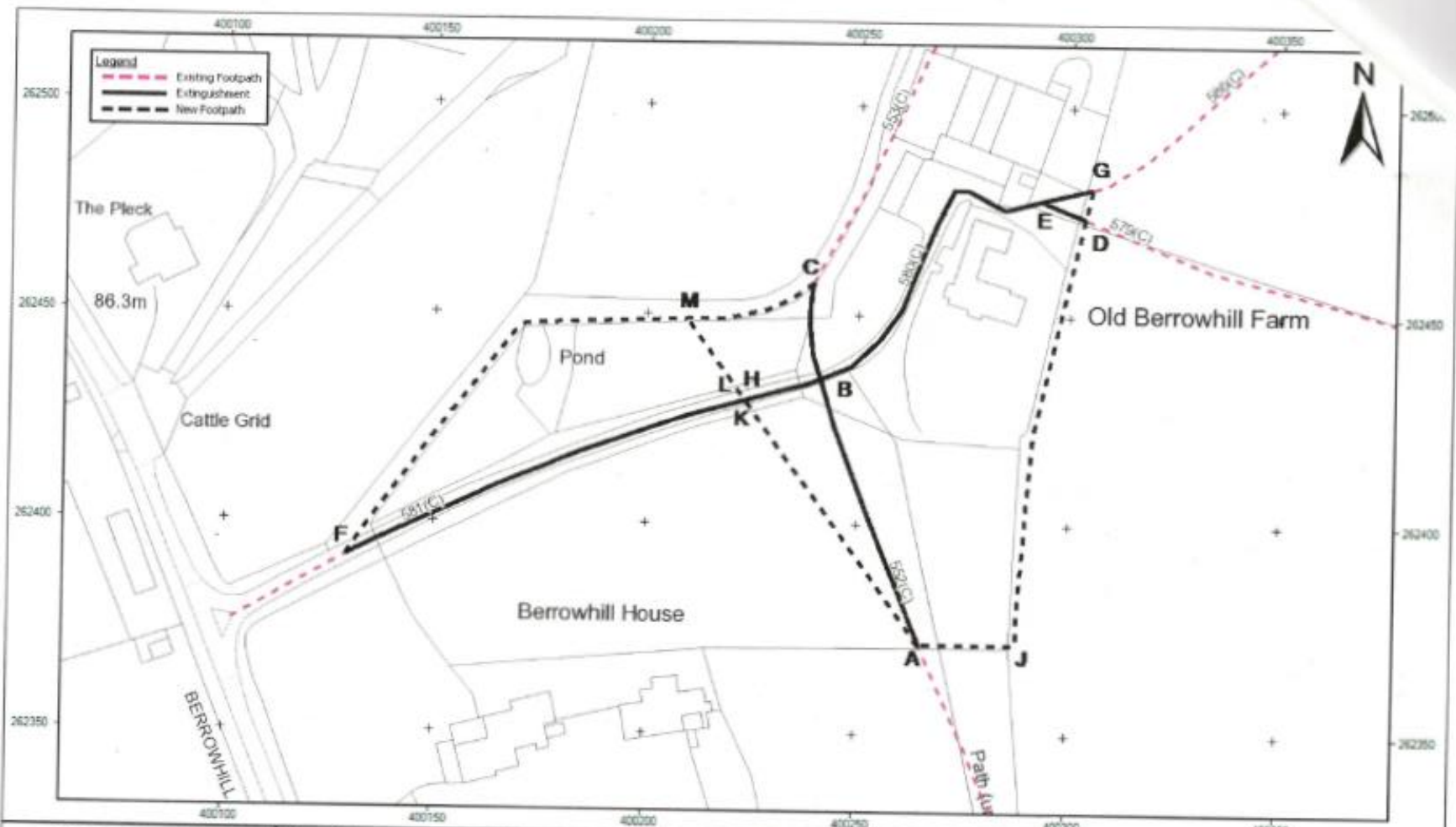

© Crown copyright and database rights 2022
 Ordnance Survey 100024230.



Indicative Scale: 1:1,250

Date Printed: 3/5/2022

D594
 District of Redditch
 Parish of Feckenham
 Diversion of footpaths FH-552(part), FH-553(part), FH-579(part), FH-580, FH-581(part), and FH-586(part)



Countryside Service
 Worcester Woods Country Park
 Wildwood Drive
 Worcester
 WR5 2LG