

R335

ACCESSIBLE SCRIPT COPIED FROM ORIGINAL SCANNED FORM

**CA16 STATEMENT**

**1. Name of appropriate authority to which the application is addressed:** Worcestershire

County Council

**2. Name and full address of applicant**

Paul Wilson, Wiggin Osborne Fullerlove, 95 The Promenade, Cheltenham, GL50 1HH

**3. Status of the Applicant**

I am:

(a) ~~The owner of the land described in paragraph 4.~~

(b) making this application and the statements/declarations it contains on behalf of

Andrew Christopher Cox and Sarah Helen Stafford Cox (Owner 1)

Manufacturing and Investment Company (Channel Islands) Limited (Owner 2)

who are the owner of the land(s) described in paragraph 4 and in my capacity as Solicitor and Agent for Owner 1 and Owner 2

**4. Insert description of the land(s) to which the application relates (including full address and postcode):**

Land belonging to Owner 1 means land on the West Side of Whitford Road registered under Title number WR46721 in the vicinity of post code B61 9AA AND

Land belonging to Owner 2 being land on the West Side of Whitford Road bordering onto the Land Owned belonging to Owner 1 and in the vicinity of post code B61 9AB

**5. Ordnance Survey six-figure grid reference(s) of a point within the area of land(s) to which the application relates:**

Land belonging to Owner 1 grid ref SO 945707

Land belonging to Owner 2 grid ref SO 945708

**6. This deposit comprises the following statement(s) and/or declarations:** Parts B & D

**PART B: Statement under section 31(6) of the Highways Act 1980**

Owner 1 is the owner of the land described in paragraph 4 of Part A of this form and shown edged red on the Plan numbered 1 accompanying this statement.

Owner 2 is the owner of the land described in paragraph 4 of Part A of this form and shown edged red on the Plan numbered 2 accompanying this statement

Ways shown with a broken line coloured orange on the accompanying plan numbered 3 are public footpaths.

No other ways over the land shown edged red on the accompanying plan numbered 3 have been dedicated as highways.

**PART C: DECLARATION**

**PART D: Statement under section 15A (1) of the Commons Act 2006**

Andrew Christopher Cox and Sarah Helen Stafford Cox (Owner 1)

Manufacturing and Investment Company (Channel Islands) Limited (Owner 2)

Are the owners of the land described in paragraph 4 of Part A of this form and shown edged red on the plan numbered 3 accompanying this statement.

Andrew Christopher Cox and Sarah Helen Stafford Cox (Owner 1) AND

Manufacturing and Investment Company (Channel Islands) Limited (Owner 2)

wish to bring to an end any period during which persons may have indulged as of right in lawful sports and pastimes on the whole or any part of the land shown edged red on the Plan numbered 3 on the accompanying plan referenced above.

**PART E:**

**PART F:**

PAUL WILSON of

WIGGIN OSBORNE FULLERLOVE, 95 THE PROMENADE, CHELTENHAM

GL50 1HH

Signed 02/10/24

## Application Form

**Form CA16****Application Form for deposits under section 31(6) of the Highways Act 1980 and section 15A(1) of the Commons Act 2006****Please read the following guidance carefully before completing this form**

1. *Guidance relating to completion of this form is available from <https://www.gov.uk/town-and-village-greens-how-to-register>. Please refer to these separate notes when completing this form.*
2. *Parts A and F must be completed in all cases.*
3. *The form must be signed and dated by, or by a duly authorised representative of, every owner of land to which the application relates who is an individual, and by the secretary or some other duly authorised officer of every owner of land to which the application relates which is a body corporate or an unincorporated association.*
4. *In the case of land in joint ownership all the joint owners must complete paragraphs 2 and 3 of Part A and complete and sign the application in Part F, unless a duly authorised representative completes and signs the form on behalf of all of the owners of the land. Paragraph 3 should be completed in full to clearly explain the capacity of each applicant e.g. trustee, landowner's managing agent, executor.*
5. *'Owner' is defined in section 61(3) of the Commons Act 2006 and section 31(7) of the Highways Act 1980 and means, broadly, a legal owner of the freehold interest in the land.*
6. *Where the application relates to more than one parcel of land, a description of each parcel should be included in Paragraph 4 of Part A and the remainder of the form should be completed to clearly identify which statement and/or declaration relates to which parcel of land. This may require the insertion of additional wording. See separate notes for further guidance. Multiple parcels of land should be clearly identified by coloured edging on any accompanying map.*
7. *Where a statement or declaration requires reference to colouring shown on an accompanying map or previously lodged map, the colouring must be clearly specified and must match that shown on the relevant map. For example, if a footpath is specified in a Part C declaration as shown coloured brown, the accompanying map or previously deposited map referred to must reflect that colouring.*
8. *An application must be accompanied by an ordnance map, or (in respect of declarations under Part C or statements under Part D of this form) refer to a map previously deposited in accordance with the Commons (Registration of Town or Village Greens) and Dedicated Highways (Landowner Statements and Declaration) (England) Regulations 2013 or (if deposited before 1st October 2013) in accordance with section 31(6) of the Highways Act 1980. Any accompanying map must be an ordnance map at a scale of not less than 1:10,560 showing the boundary of the land to which the application relates in coloured edging.*
9. *An application must be accompanied by the requisite fee – please ask the appropriate authority for details.*

10. *'Appropriate authority' means (a) in relation to a map or statement deposited or declaration lodged under section 31(6) of that Act, an appropriate council (as defined in section 31(7) of the Highways Act 1980); and (b) in relation to a statement and map deposited under section 15A(1) of the 2006 Act, a*

*commons registration authority (defined in section 4 of the Commons Act 2006 and section 2 of the Commons Registration Act 1965). In practice, the appropriate council and commons registration authority will usually be the same body.*

**PART A: Information relating to the applicant and land to which the application relates  
(all applicants must complete this Part)**

1. Name of appropriate authority to which the application is addressed:

Worcestershire County Council

2. Name and full address (including postcode) of applicant:

Paul Wilson  
Wiggin Osborne Fullerlove  
95 The Promenade  
Cheltenham  
GL50 1HH

3. Status of applicant (tick relevant box or boxes):

I am

(a)  the owner of the land(s) described in paragraph 4.

(b)  making this application and the statements/declarations it contains on behalf of

Andrew Christopher Cox and Sarah Helen Stafford Cox (Owner 1)

Manufacturing and Investment Company (Channel Islands) Limited (Owner 2)

who are the owner of the land(s) described in paragraph 4 and in my capacity as Solicitor  
and Agent for Owner 1 and Owner 2

4. Insert description of the land(s) to which the application relates (including full address and postcode):

Land belonging to Owner 1 means land on the West Side of Whitford Road registered under Title  
number WR46721 in the vicinity of post code B61 9AA AND

Land belonging to Owner 2 being land on the West Side of Whitford Road bordering onto the Land  
Owned belonging to Owner 1 and in the vicinity of post code B61 9AB

5. Ordnance Survey six-figure grid reference(s) of a point within the area of land(s) to which the  
application relates (if known): Land belonging to Owner 1 grid ref SO 945707

Land belonging to Owner 2 grid ref SO 945708

6. This deposit comprises the following statement(s) and/or declarations

**PART B: Statement under section 31(6) of the Highways Act 1980**

Owner 1 is the owner of the land described in paragraph 4 of Part A of this form and shown edged red on  
the Plan numbered 1 accompanying this statement.

Owner 2 is the owner of the land described in paragraph 4 of Part A of this form and shown edged red on  
the Plan numbered 2 accompanying this statement

Ways shown with a broken line coloured orange on the accompanying plan numbered 3 are public footpaths.

No other ways over the land shown edged red on the accompanying plan numbered 3 have been dedicated as highways.

**PART D: Statement under section 15A(1) of the Commons Act 2006**

Andrew Christopher Cox and Sarah Helen Stafford Cox (Owner 1)

Manufacturing and Investment Company (Channel Islands) Limited (Owner 2)

Are the owners of the land described in paragraph 4 of Part A of this form and shown edged red on the plan numbered 3 accompanying this statement.

Andrew Christopher Cox and Sarah Helen Stafford Cox (Owner 1) AND

Manufacturing and Investment Company (Channel Islands) Limited (Owner 2)

wish to bring to an end any period during which persons may have indulged as of right in lawful sports and pastimes on the whole or any part of the land shown edged red on the Plan numbered 3 on the accompanying plan referenced above.



**PART E: Additional information relevant to the application**  
*(insert any additional information relevant to the application)*

**PART F: Statement of Truth**  
*(all applicants must complete this Part)*

**WARNING:** If you dishonestly enter information or make a statement that you know is, or might be, untrue or misleading, and intend by doing so to make a gain for yourself or another person, or to cause loss or the risk of loss to another person, you may commit the offence of fraud under section 1 of the Fraud Act 2006, the maximum penalty for which is 10 years' imprisonment or an unlimited fine, or both.

I BELIEVE THAT THE FACTS AND MATTERS CONTAINED IN THIS STATEMENT ARE TRUE

Signature (of the person making the statement of truth):



Print full name: PAUL WILSON OF  
WIGGIN OSBORNE FULLERLOVE  
95 THE PROMENADE  
CHELTENHAM  
GL50 1HH

Acting as Agent for Owner 1 and Owner 2

Date: 2<sup>nd</sup> October 2024

**You should keep a copy of the completed form**

**Data Protection Act 1998 - Fair Processing Notice**

The purpose of this Fair Processing Notice is to inform you of the use that will be made of your personal data, as required by the Data Protection Act 1998.

The appropriate authority (see explanation of definition in above guidance notes) in England is the data controller in respect of any personal data that you provide when you complete this form.

The information that you provide will be used by the appropriate authority in its duties to process applications to deposit statements, maps and declarations under section 31(6) the Highways Act 1980 and statements under section 15A(1) of the Commons Act 2006. The information you provide will also be used by the appropriate authority in its duty to update the registers in which details of such deposits are recorded under the Dedicated Highways (Registers under Section 31A of the Highways Act 1980) (England) Regulations 2007 and the Commons (Registration of Town or Village Greens) and Dedicated Highways (Landowner Statements and Declarations) (England) Regulations 2013.

The appropriate authority is required by the legislation above to maintain a register which holds information provided in this form, which can be inspected online or in person by members of the public on request. It may also be required to release information, including personal data and commercial information, on request under the Environmental Information Regulations 2004 or the Freedom of Information Act 2000. However, the appropriate authority will not permit any unwarranted breach of confidentiality nor will they act in contravention of their obligations under the Data Protection Act 1998.



HM Land Registry  
Official copy of  
title plan

Title number **WR46721**  
Ordnance Survey map reference **SO9470NE**  
Scale **1:2500 reduced from 1:1250**  
Administrative area **Worcestershire :**  
**Bromsgrove**

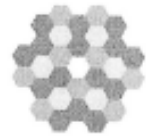

*Owner 1 Plan 1*

© Crown Copyright. Produced by HM Land Registry. Reproduction in whole or in part is prohibited without the prior written permission of Ordnance Survey. Licence Number 100026316

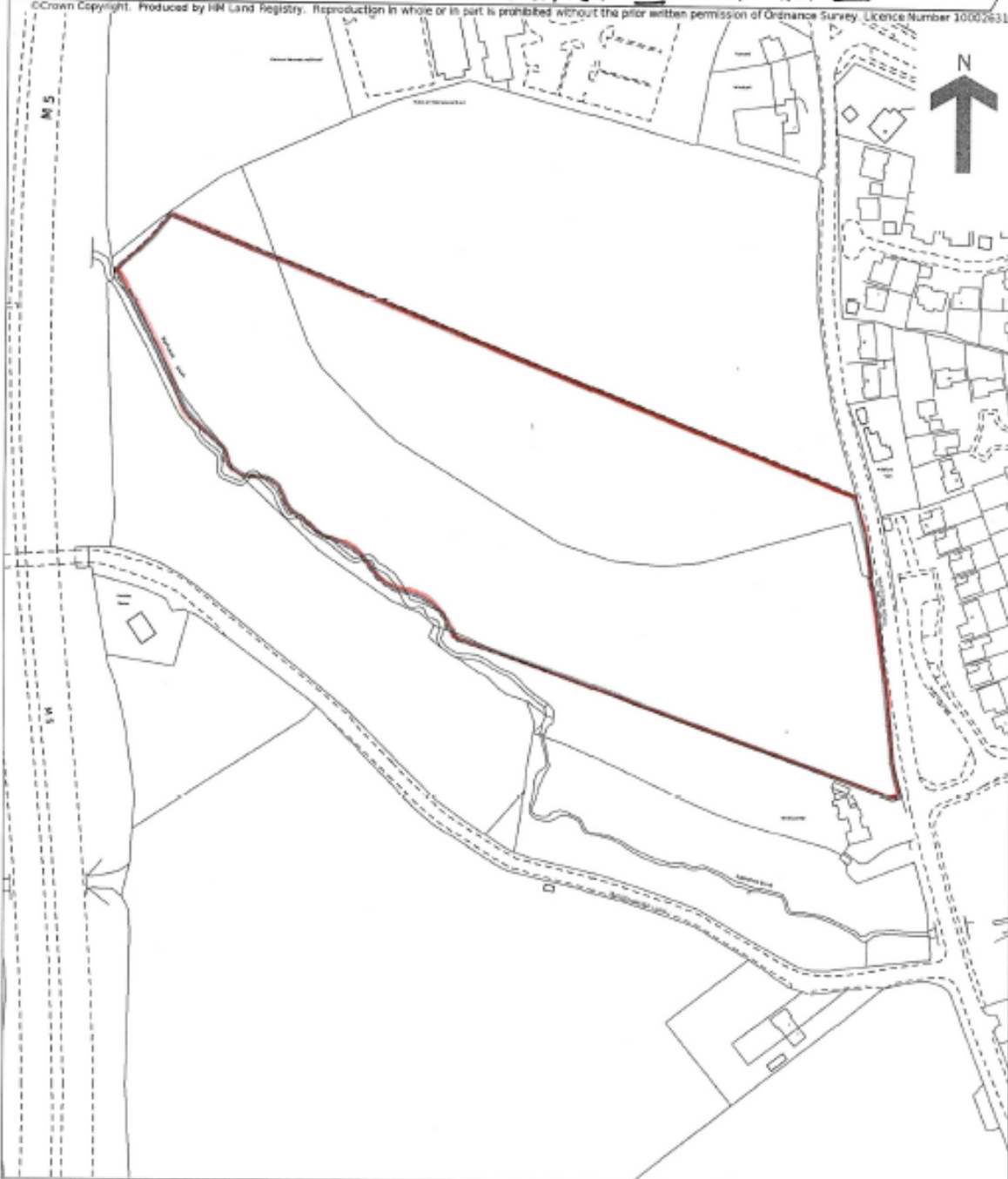



Owner 2 Plan 2



0 10 20 30 40 50 60 70 80 100m

Map scale 1:2500

© Crown copyright and database rights 2024 Ordnance Survey 100026316

This map is for reference purposes only. You are not permitted to copy, sub-license, distribute or sell any of this data to third parties in any form.

Data last updated 10:00pm 17 SEPTEMBER, 2024