

NOTICE OF CONFIRMATION OF AN ORDER

HIGHWAYS ACT 1980
WILDLIFE AND COUNTRYSIDE ACT 1981

WORCESTERSHIRE COUNTY COUNCIL

DIVERSION OF FOOTPATHS SY-573, SY-574 AND SY-575, (FORMERLY FOOTPATH 21) IN THE PARISH OF SHRAWLEY

On 7th March 2024, Worcestershire County Council confirmed the above order made under Section 119 of the Highways Act 1980, and Section 53A(2) of the Wildlife and Countryside Act 1981.

The effect of the order as confirmed is to divert paths:

SY-573 running from OSGR SO 7953 6423 (point A on the order map). the footpath proceeds in an east-north-easterly direction, along a private driveway, for 97 metres to terminate at its junction with footpath SY-574 and SY-575 at OSGR SO 7962 6426 (point B on the order map), to a line running from OSGR SO 7954 6418 (point H on the order map); the path proceeds in an east south-easterly direction, through a gate at OSGR SO 7954 6417 (point G on the order map) and passing through a wooded copse for 15 metres, then turns in an east by northerly direction for 84 metres across a field to a gate at OSGR SO 7966 6425 (point E on the order map)), as shown on the order map.

SY-574 running from OSGR SO 7962 6426 (point B on the order map). The path proceeds in a north-easterly direction across a paddock for 69 metres to OSGR SO 7967 6431 (Point C on the Order map), then turns in a north-north-easterly direction for 67 metres, through a gate, to terminate at OSGR SO 7969 6437 (point D on the order map), to a line running from OSGR SO 7966 6425 (point E on the order map). the path proceeds in a north north-easterly direction for 119 metres, along the field edge, then turns west north-westerly for 12 metres to terminate at its junction with the existing footpath SY-574 at OSGR SO 7696 6437 (point D on the order map), as shown on the order map.

SY-575 running from OSGR SO 7962 6426 (point B on the order map) the path proceeds in an easterly direction across a paddock of 40 metres to OSGR SO 7966 6426 (point E on the order map), to a line running commencing at a gate at OSGR SO 7964 6418 (point F on the order map). the path then continues in a north easterly direction for 74 metres, along the field edge, to its junction with footpath SY-574 at OSGR SO 7966 6426 (point E on the order map), as shown on the order map.

A copy of the order as confirmed and the order map have been placed and may be seen free of charge at Stourport on Severn Library, Civic Centre, New Street, Stourport on Severn, DY13 8UN, during normal opening hours. Library computer use can be pre booked on 01905 822722 or via the following email address: StourportLIB@worcestershire.gov.uk (copies may be printed at the library; usual charges apply). The documents can also be viewed online at:

The documents can also be viewed online at:

[Public rights of way order consultations | Worcestershire County Council](#)

The order comes into force as of 7th march 2024 but if any person aggrieved by the order wants to question its validity or that of any provision contained in it, on the ground that it is not within the powers of the Highways Act 1980 as amended, or on the ground that any requirement of the Act, as amended, or of any regulation made under the Act, has not been complied with in relation to the order, he or she may, under paragraph 2 of Schedule 2 to the Act as applied by paragraph 5 of Schedule 6 to the Act, within 6 weeks from the date of the notice, make an application to the High Court.

Dated 12th September 2024

THOMAS POLLOCK, Head of Commercial Law, Legal and Governance

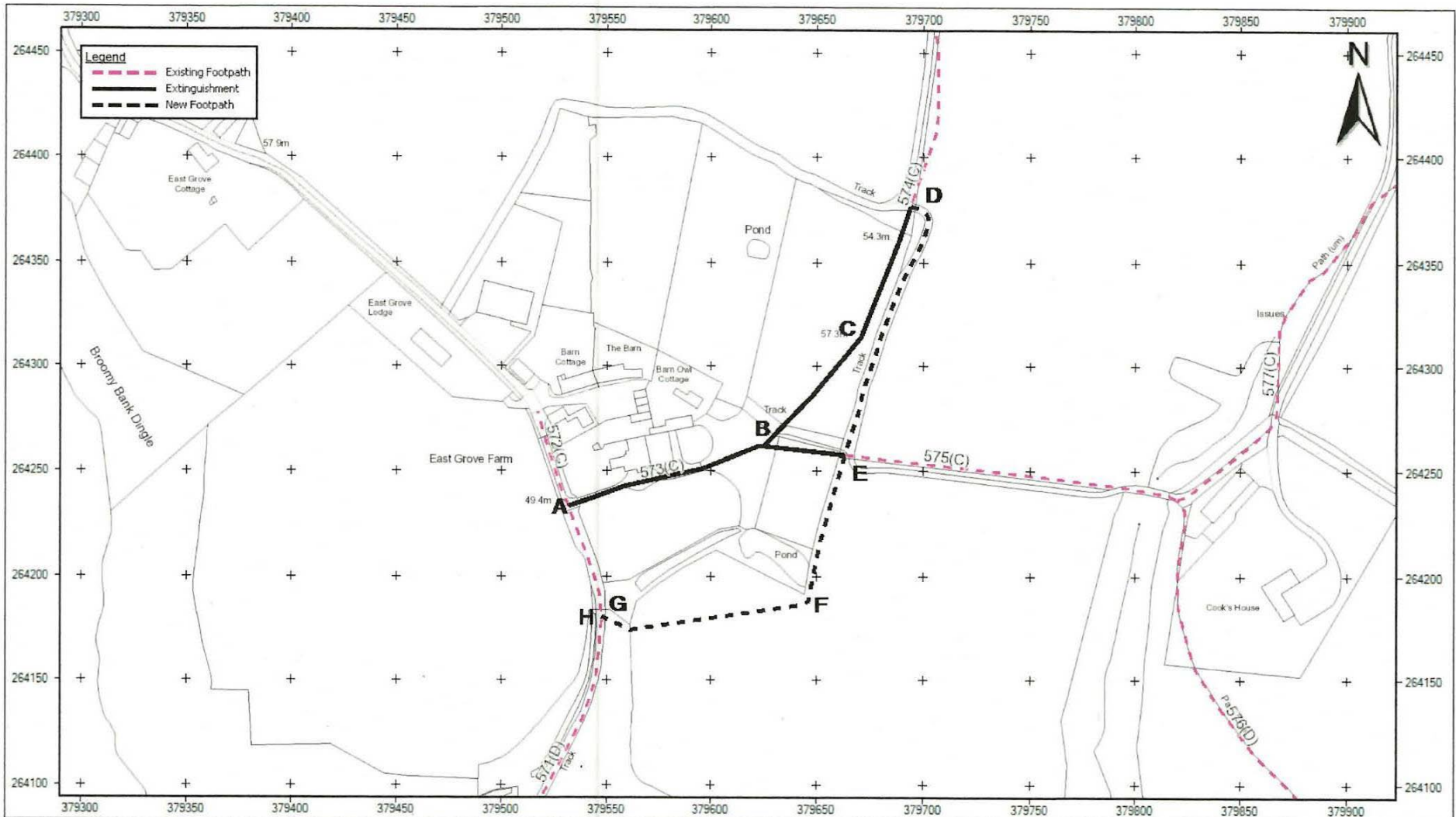

© Crown copyright and database rights 2021
 Ordnance Survey 100024230.

Indicative Scale: 1:2,500

Date Printed: 10/2/2021

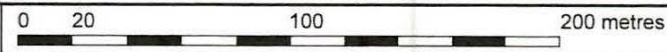

D579
 District of Malvern Hills
 Parish of Shrawley
 Diversion of footpaths SY-573 and SY-574(part), and extinguishment of SY-575(part)



Countryside Service
 Worcester Woods Country Park
 Wildwood Drive
 Worcester
 WR5 2LG