

RAIL CROSSING EXTINGUISHMENT ORDER

**HIGHWAYS ACT 1980, SECTION 118A
WILDLIFE AND COUNTRYSIDE ACT 1981**

WORCESTERSHIRE COUNTY COUNCIL

**STOPPING UP OF FOOTPATHS
TC-504 (FORMERLY FOOTPATH 1) IN THE PARISH OF TUTNALL AND COBLEY
AND
LK-524 (PART) (FORMERLY FOOTPATH 61) IN THE PARISH OF LICKEY**

PUBLIC PATH EXTINGUISHMENT AND DEFINITIVE MAP MODIFICATION ORDER 2024

This Order is made by Worcestershire County Council ('the authority') under Section 118A of the Highways Act 1980 ('the 1980 Act').

This Order is also made under section 53A(2) of the Wildlife and Countryside Act 1981 ("the 1981 Act") because it appears to the authority that the County of Worcestershire definitive map and statement require modification in consequence of the occurrence of an event specified in section 53(3)(a)(i) of the 1981 Act, namely, the diversion (as authorised by this Order) of a highway shown or required to be shown in the map and statement.

The footpaths in the authority's area described below crosses a railway otherwise than by a tunnel or bridge.

It appears to the authority that it is expedient in the interests of the safety of members of the public using, or likely to use, the said footpaths that they should be stopped up.

Bromsgrove District Council has been consulted on the making of the Order as required by Section 120(2) of the 1980 Act.

Worcestershire County Council has required the operator of the railway to enter into an agreement with it to meet any expenses which are incurred in the erection or maintenance of barriers and signs.

THIS ORDER EXTINGUISHES the public right of way over the land situate at Lickey and Tutnall & Cobley shown by a continuous bold line on the map attached to this order and described in the schedule on the date of confirmation of this order and thereupon the County of Worcestershire definitive map and statement shall be modified accordingly.

The Common Seal of
Worcestershire County Council
was affixed hereto in the presence of:-

SCHEDULE

PART 1

Description of Footpaths to be Extinguished

LK-524 (formerly No. 61) (Part)

The entire width and length of the footpath to be extinguished commences at Ordnance Survey Grid Reference (OSGR) SO 9965 7231 (point A on the order plan). It proceeds in a southeasterly direction for 50 metres to meet footpath TC-504 at a point on the parish boundary with Tutnall & Cobley at OSGR SO 9968 7227 (point B on the order plan).

TC-504 (formerly No. 1)

The entire width and length of the footpath to be extinguished commences from footpath LK-524 at a point on the parish boundary with Lickey at OSGR SO 9968 7227 (point B on the order plan). It proceeds in a southeasterly direction for 16 metres to a junction with footpaths TC-505 and TC-503 at OSGR SO 9968 7226 (point C on the order plan).

PART 2

VARIATION OF DEFINITIVE STATEMENT

Variations of Statement for Lickey LK 061

PARISH OF Lickey

DISTRICT OF **Bromsgrove**

NO. 524, formerly No. 61

MAP REF. 6-inch Ordnance Map Reference. Worcs.

Definitive Map grid reference: 97-16

CLASSIFICATION: Footpath

LOCATION:

Linthurst Newtown in a southeasterly direction to **terminate** on **southern edge of Fairways Drive cul-de-sac at (OSGR) SO 9965 7231**. ~~railway boundary of Bromsgrove U.D.C and Rural D.C. areas.~~

Formerly in Bromsgrove Parish.

Length: ~~0.07~~ **0.04**

DESCRIPTION:

Tarmac surface from Linthurst Newtown Road to southern edge of Fairways Drive cul-de-sac.

~~Footpath well defined across allotments.~~

~~1. Stile 4'6" high rails with step, with wooden fence either side.~~

Variations of Statement for Tutnall & Cobley TC 001

PARISH OF Tutnall & Cobley

DISTRICT OF Bromsgrove

NO. ~~504, 502, 505, 501, 503, 500~~ formerly No. 1

MAP REF. 6-inch Ordnance Map Reference. Worcs. XVI. S.W.

Definitive Map grid reference: 97-16

CLASSIFICATION: Footpaths (~~Three~~ **Two**)

LOCATION:

Agmore Road. Commencing on north side of road at drive leading to Golf Club House, proceeding in a north easterly direction south-east of Club House and continuing across golf course to Sidnals Road.

~~Branch Footpaths. Commencing at the Boundary with the Bromsgrove Urban District, west of railway, continuation of footpath from Linthurst Road, Bromsgrove Urban District, crossing railway,~~ **Commencing from a junction with footpaths TC-505 and TC-503 at OSGR SO 9968 7226 (point C on the order plan)**- one branch proceeding in a southerly direction to join main footpath, and the second branch in a south easterly direction to join main footpath at its termination at Sidnals Road.

Length: ~~0.672~~ **0.671**

DESCRIPTION:

Metalled drive to Club House; golf course defined track.

~~Branch footpaths. Level crossing at railway;~~ golf course, defined tracks.

One field gate, one iron kissing gate, three stiles.

Worcestershire County Council in exercise of the powers conferred upon them in that behalf
Confirmed this order on 30th May 2024 Signed by the Principal Solicitor

RAIL CROSSING EXTINGUISHMENT ORDER

HIGHWAYS ACT 1980, SECTION 118A
WILDLIFE AND COUNTRYSIDE ACT 1981

WORCESTERSHIRE COUNTY COUNCIL

STOPPING UP OF FOOTPATHS
TC-504 (FORMERLY FOOTPATH 1) IN THE PARISH OF TUTNALL AND COBLEY
AND
LK-524 (PART) (FORMERLY FOOTPATH 61) IN THE PARISH OF LICKEY

PUBLIC PATH EXTINGUISHMENT AND DEFINITIVE MAP MODIFICATION ORDER 2024

This Order is made by Worcestershire County Council ('the authority') under Section 118A of the Highways Act 1980 ('the 1980 Act').

This Order is also made under section 53A(2) of the Wildlife and Countryside Act 1981 ('the 1981 Act') because it appears to the authority that the County of Worcestershire definitive map and statement require modification in consequence of the occurrence of an event specified in section 53(3)(a)(i) of the 1981 Act, namely, the diversion (as authorised by this Order) of a highway shown or required to be shown in the map and statement.

The footpaths in the authority's area described below crosses a railway otherwise than by a tunnel or bridge.

It appears to the authority that it is expedient in the interests of the safety of members of the public using, or likely to use, the said footpaths that they should be stopped up.

Bromsgrove District Council has been consulted on the making of the Order as required by Section 120(2) of the 1980 Act.

Worcestershire County Council has required the operator of the railway to enter into an agreement with it to meet any expenses which are incurred in the erection or maintenance of barriers and signs.

THIS ORDER EXTINGUISHES the public right of way over the land situate at Lickey and Tutnall & Cobley shown by a continuous bold line on the map attached to this order and described in the schedule on the date of confirmation of this order and thereupon the County of Worcestershire definitive map and statement shall be modified accordingly.

The Common Seal of
Worcestershire County Council
was affixed hereto in the presence of:-



Thomas Pollock
Head of Commercial Law
(Legal & Governance)



29.2.24

SCHEDULE

PART 1

Description of Footpaths to be Extinguished

LK-524 (formerly No. 61) (Part)

The entire width and length of the footpath to be extinguished commences at Ordnance Survey Grid Reference (OSGR) SO 9965 7231 (point A on the order plan). It proceeds in a southeasterly direction for 50 metres to meet footpath TC-504 at a point on the parish boundary with Tutnall & Cobley at OSGR SO 9968 7227 (point B on the order plan).

TC-504 (formerly No. 1)

The entire width and length of the footpath to be extinguished commences from footpath LK-524 at a point on the parish boundary with Lickey at OSGR SO 9968 7227 (point B on the order plan). It proceeds in a southeasterly direction for 16 metres to a junction with footpaths TC-505 and TC-503 at OSGR SO 9968 7226 (point C on the order plan).

PART 2

VARIATION OF DEFINITIVE STATEMENT

Variations of Statement for Lickey LK 061

PARISH OF Lickey

DISTRICT OF Bromsgrove

NO. 524, formerly No. 61

MAP REF. 6-inch Ordnance Map Reference. Worcs.

Definitive Map grid reference: 97-16

CLASSIFICATION: Footpath

LOCATION:

Linthurst Newtown in a southeasterly direction to terminate on southern edge of Fairways Drive cul-de-sac at (OSGR) SO 9965 7231. ~~railway—boundary of Bromsgrove U.D.C and Rural D.C. areas.~~

Formerly in Bromsgrove Parish.

Length: ~~0.07~~ 0.04

DESCRIPTION:

Tarmac surface from Linthurst Newtown Road to southern edge of Fairways Drive cul-de-sac.

Footpath well defined across allotments.

1. ~~Stile 4'6" high rails with step, with wooden fence either side.~~

Variations of Statement for Tutnall & Cobley TC 001

PARISH OF Tutnall & Cobley

DISTRICT OF Bromsgrove

NO. 504, 502, 505, 501, 503, 500 formerly No. 1

MAP REF. 6-inch Ordnance Map Reference. Worcs. XVI. S.W.

Definitive Map grid reference: 97-16

CLASSIFICATION: Footpaths (~~Three~~ Two)

LOCATION:

Agmore Road. Commencing on north side of road at drive leading to Golf Club House, proceeding in a north easterly direction south-east of Club House and continuing across golf course to Sidnals Road.

Branch Footpaths. ~~Commencing at the boundary with the Bromsgrove Urban District, west of railway, continuation of footpath from Linthurst Road, Bromsgrove Urban District, crossing railway.~~ **Commencing from a junction with footpaths TC-505 and TC-503 at OSGR SO 9968 7226 (point C on the order plan)**: one branch proceeding in a southerly direction to join main footpath, and the second branch in a south easterly direction to join main footpath at its termination at Sidnals Road.

Length: 0.672 **0.671**

DESCRIPTION:

Metalled drive to Club House; golf course defined track.

Branch footpaths. ~~Level crossing at railway;~~ golf course, defined tracks.

One field gate, one iron kissing gate, three stiles.

Worcestershire County Council in exercise of the powers conferred upon them in that behalf confirmed this order on: 30th May 2024

Clare Taylor

Principal Solicitor

CLARE TAYLOR

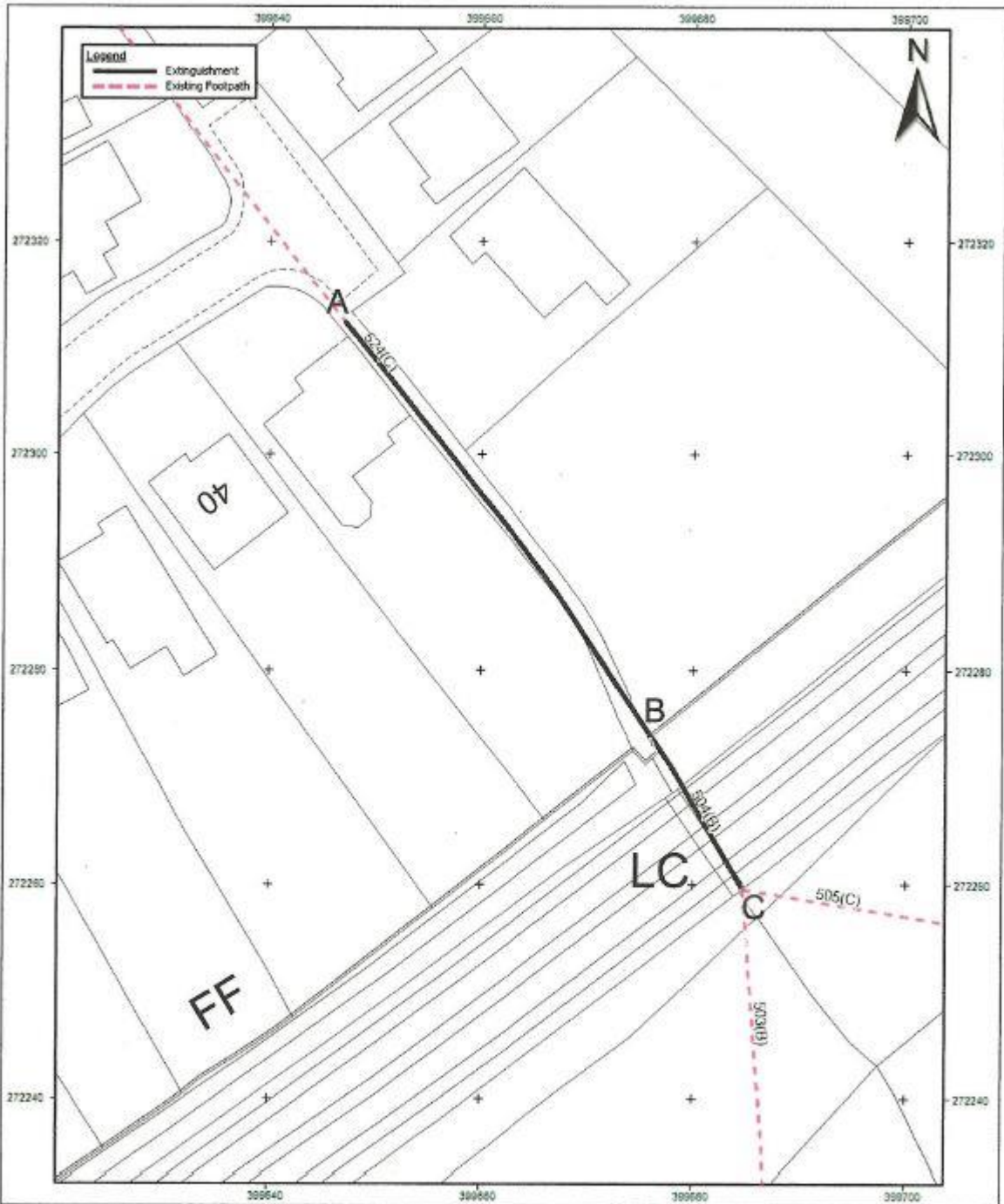

<p>© Crown copyright and database rights 2024 Ordnance Survey AC0000809204.</p>	<p>0 2 10 20 metres</p> <p>Extinguishment of Footpath LK-542 (Part) and TC-504 - Order Plan</p>	<p> worcestershire county council</p>
<p>Indicative Scale: 1:500</p>	<p>Made under Section 118A of the Highways Act 1980 and Section 53 of the Wildlife and Countryside Act 1981</p>	<p>Countryside Service Worcester Woods Country Park Wildwood Drive Worcester WR5 2LG</p>
<p>Date Printed: 6/2/2024</p>		