

# **Order and Plan for Clarence Road, Malvern**

## **Statement of Reasons for proposing to make an Order under the Road Traffic Regulation Act 1984**

### **WORCESTERSHIRE COUNTY COUNCIL (MALVERN HILLS DISTRICT) (CIVIL ENFORCEMENT AREA) (WAITING RESTRICTIONS AND STREET PARKING PLACES) CONSOLIDATION ORDER 2013 (VARIATION) ORDER 2024 [PROHIBITION OF WAITING ON CLARENCE ROAD, MALVERN]**

Worcestershire County Council have made this Order for facilitating the safe passage on the road or any other road of any class of traffic and for avoiding danger to persons or other traffic using the road or any other road or for preventing the likelihood of any such danger arising.

It is considered that the Order will contribute to the securing of the expeditious, safe and convenient movement of all traffic (including pedestrians) and will have no adverse effect on other considerations contained in s.122 Road Traffic Regulation Act 1984.

THOMAS POLLOCK  
Head of Commercial Law  
Legal and Governance

County Hall  
Spetchley Road  
Worcester  
WR5 2NP

# The order under the Road Traffic Regulation Act 1984

## **ROAD TRAFFIC REGULATION ACT 1984 WORCESTERSHIRE COUNTY COUNCIL (MALVERN HILLS DISTRICT) (CIVIL ENFORCEMENT AREA) (WAITING RESTRICTIONS AND STREET PARKING PLACES) CONSOLIDATION ORDER 2013 (VARIATION) ORDER 2024 [PROHIBITION OF WAITING ON CLARENCE ROAD, MALVERN]**

Worcestershire County Council in exercise of their powers under Section 1(1), 2 (1) to (3), 4(2) and 124 and Part IV of Schedule 9 of the Road Traffic Regulation Act 1984 (which said Act is hereinafter referred to as "the Act of 1984") and of all other powers them enabling in that behalf, and after consultation with the Chief Officer of Police in accordance with Part III of Schedule 9 to the said Act of 1984, hereby make the following Order:-

1. The Worcestershire County Council (Malvern Hills District) (Civil Enforcement Area) (Waiting Restrictions and Street Parking Places) Consolidation Order 2013 is hereby varied by the attachment thereto of the plan attached to this Order (which has the effect of imposing on the road and sides of road identified in the plan attached to this Order a prohibition of waiting at any time in accordance with the provisions of the Consolidation Order).
2. The Order shall come into operation on 20 June 2024 and may be cited as Worcestershire County Council (Malvern Hills District) (Civil Enforcement Area) (Waiting Restrictions and Street Parking Places) Consolidation Order 2013 (Variation) Order 2024 [Prohibition of Waiting on Clarence Road, Malvern].

Dated: 30 May 2024

The Common Seal of )  
Worcestershire County Council was )  
hereunto affixed in the presence of:-)

L.S.  
Thomas Pollock  
Head of Commercial Law  
Legal and Governance

# Signed scanned copy of the sealed order

ROAD TRAFFIC REGULATION ACT 1984

WORCESTERSHIRE COUNTY COUNCIL

(MALVERN HILLS DISTRICT)  
(CIVIL ENFORCEMENT AREA)

(WAITING RESTRICTIONS AND STREET PARKING PLACES)  
CONSOLIDATION ORDER 2013 (VARIATION) ORDER 2024

[PROHIBITION OF WAITING ON CLARENCE ROAD, MALVERN]

Worcestershire County Council in exercise of their powers under Section 1(1), 2 (1) to (3), 4(2) and 124 and Part IV of Schedule 9 of the Road Traffic Regulation Act 1984 (which said Act is hereinafter referred to as "the Act of 1984") and of all other powers them enabling in that behalf, and after consultation with the Chief Officer of Police in accordance with Part III of Schedule 9 to the said Act of 1984, hereby make the following Order:-

1. The Worcestershire County Council (Malvern Hills District) (Civil Enforcement Area) (Waiting Restrictions and Street Parking Places) Consolidation Order 2013 is hereby varied by the attachment thereto of the plan attached to this Order (which has the effect of imposing on the road and sides of road identified in the plan attached to this Order a prohibition of waiting at any time in accordance with the provisions of the Consolidation Order).
2. The Order shall come into operation on 20 June 2024 and may be cited as Worcestershire County Council (Malvern Hills District) (Civil Enforcement Area) (Waiting Restrictions and Street Parking Places) Consolidation Order 2013 (Variation) Order 2024 [Prohibition of Waiting on Clarence Road, Malvern].

Dated: 30 May 2024

The Common Seal of )  
Worcestershire County Council was )  
hereunto affixed in the presence of:-)

*Clare Taylor*  
CLARE TAYLOR  
PRINCIPAL SOLICITOR



## Map and plan of the area

Map of Clarence Road, Malvern and the prohibition of waiting zones implemented by the above order.

### Description of the map

The map shows the prohibition of waiting zones on Clarence Road, **Malvern:-**  
**Clarence Road (south side)** – From a point 52m east of its junction with Priory Road for 60m in an easterly direction.

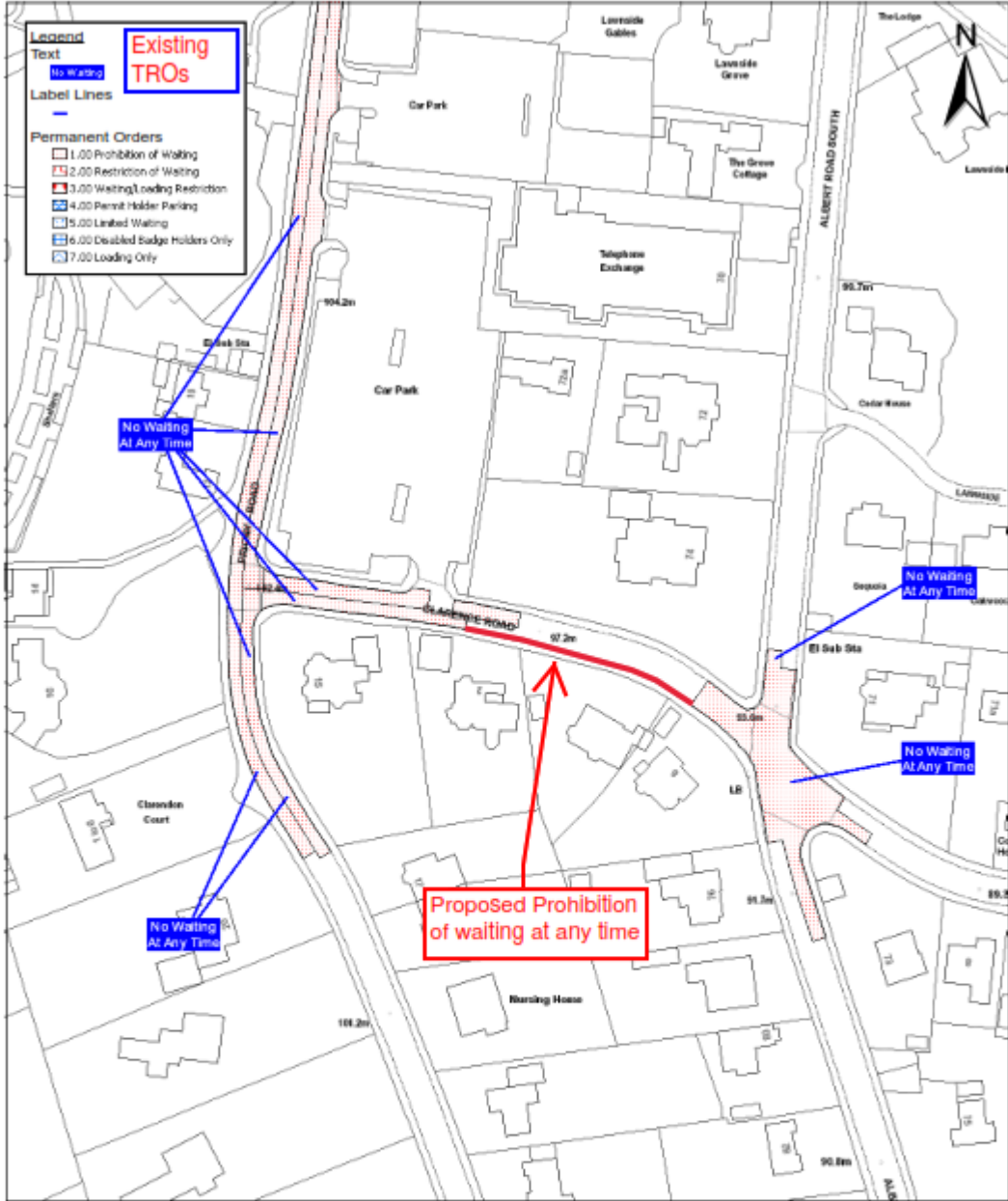

© Crown copyright and database rights 2019  
 Ordnance Survey 100024230.

Scale: 1:1250      At A4

T.2023.1132

### Clarence Road, Malvern Proposed Traffic Regulation Order

 **worcestershire**  
 county council

Worcestershire County Council  
 County Hall  
 Spetchley Road  
 Worcester  
 WR5 2NP